



## 24 Villa Park Lodge Road

Cranfield, MK43 0BG

£120,000

\*IN NEED OF FULL REFURBISHMENT\*

Inside the property you are met with a hallway area which leads to the living room, perfect for entertaining friends or winding down in the evening. The accommodation briefly comprises of a main bedroom which has its own ensuite and then a second bedroom and a main bathroom. There is also a kitchen which has a backdoor leading to the low maintenance garden area which boasts stunning views over open countryside. This property also has a driveway with parking for one car.

This exclusive residential park home estate is for individuals who are semi or fully retired over the age of 55, it offers a warm close-knit community feel. There is a monthly ground rent/service charge payable of approximately £250 a month. There is also a strict no pets rule. It is situated a small walk away from the amenities in Cranfield and is also close to the community centre. Cranfield also has public transport services that run into Milton Keynes.

# CRANES

- IN NEED OF RREFURBISHMENT
- STUNNING COUNTRYSIDE VIEWS
- OVER 55s
- GOOD SIZE PLOT
- ENSUITE
- 2 BEDROOMS
- NO UPPER CHAIN

### Viewing

Please contact our Cranes Estate Agents Office on 01234 750900 if you wish to arrange a viewing appointment for this property or require further information.

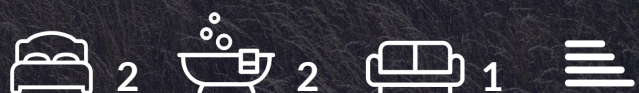



Floor Plan

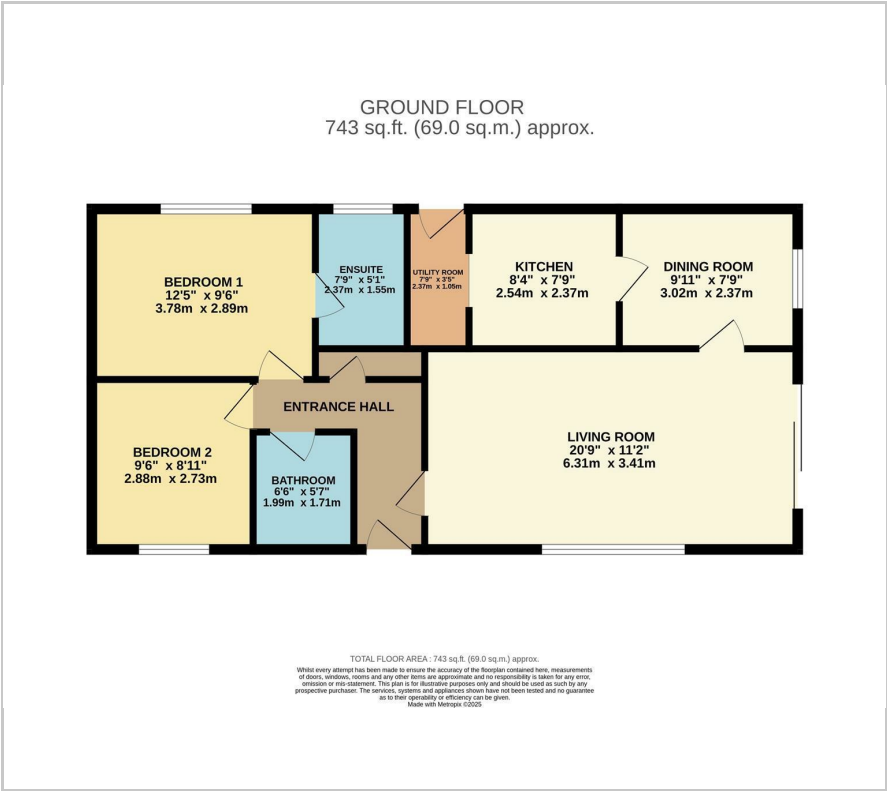

Area Map



Energy Efficiency Graph

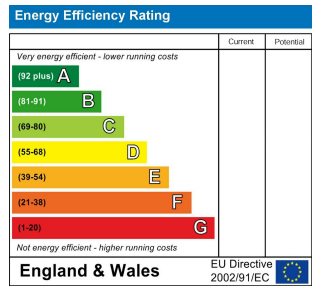

These particulars, whilst believed to be accurate are set out as a general outline only for guidance and do not constitute any part of an offer or contract. Intending purchasers should not rely on them as statements of representation of fact, but must satisfy themselves by inspection or otherwise as to their accuracy. No person in this firm's employment has the authority to make or give any representation or warranty in respect of the property.